

TELESCOPIC ARM

MADE IN
cosben



cosben[®]
EQUIPMENT CONSTRUCTION
www.cosben-it.com

PRODUCTIVITY

The excavators equipped with clamshell telescopic arms have been designed to boost productivity on complex and challenging excavation projects. They can be used to remove soil from depths till 40 meters below ground and load trucks to transport the material swiftly off site. The excavator range can be relied upon to operate smoothly and safely to meet tight deadlines.

CLAMSHELL TELESCOPIC ARM

Using a technologically advanced combination of rope and hydraulic cylinders, the telescopic arm extends and retracts smoothly with a full load in a matter of seconds. The hydraulic circuit for the excavator range, offer even higher levels of productivity. They have proved to be quicker than the traditional skips and crane method of below-ground excavation, for example. The new models can also be fitted with an optional Shuttle Q-Fit, which provides greater versatility on busy job sites.

WIRE ROPES SYSTEM

One of several safety features incorporated into the design of the excavator range of telescopic arm excavators is the wire ropes system. This means that, in the unlikely event that one rope should break, the other will hold the telescopic arm firmly in place, until it can be repaired. This is one of the many ways in which the excavator contributes to the safe and successful operation of any job site.

INCORPORATED COUNTERWEIGHT

Another beneficial feature of the excavator range of telescopic excavators is the availability of an additional counterweight. This is incorporated between the machine and the original counterweight, and not changing the appearance of the excavator.

Therefore, it allows the machine to be used for a variety of operations on the job site, enhancing its versatility and overall levels of productivity.

SAFETY VALVE

The telescopic arm is also equipped with a safety valve, which, in the unlikely event of a damaged cylinder, will prevent any other impact on the machine or the environment.



HIGH LEVELS OF EFFICIENCY



The reliable and efficient operation of your excavator can have a strong impact on the success of your business. Taking this into account, Cosben engineers have designed the clamshell telescopic models with several performance-enhancing features. Our ultimate aim is to produce machines that will enable you to complete underground construction projects safely and on schedule. We believe the performance of the excavator range of clamshell telescopic excavators will extend beyond your expectations, providing you with a quick return on your investment.

VISION SOLUTION CAMERA, ADVANTAGES:

The excavator telescopic arm it's an example of complex machines where good vision is essential to allow the work to progress smoothly, as Cosben's vision solution allows the safety condition working and improves operating efficiency in the job-site. The operator must often move into unnatural positions to be able to follow what is going on, and this can lead to injury, or forced to stop working. An Cosben vision solution enables the driver to maintain a correct posture and allows him to work in more comfort, offering a dual benefit!

SHUTTLE Q-Fit "quick coupling"

The TA excavator can also be fitted with an optional Shuttle Q-Fit "quick coupling", which provides greater versatility on busy job sites. Easy to connect and disconnect the Shuttle Q-Fit significantly reduces the time for disassembly / assembly of the clamshell telescopic arm to the excavator, containing substantially the additional costs in transport of excavator.

WARNING SAFETY ALARMS

The safe performance of the excavator with telescopic arm is aided by the use of warning lights and safety alarms. For example, if either of the two ropes were to break suddenly or extend too far, an indication light and a warning buzzer would alert the operator immediately. In addition, a warning buzzer will alert the operator if too much pressure is applied once the clamshell bucket has reached the ground and is excavating the material.

FRONT HEAD'S LINK

When the operators need to work with two pins on mounting as dredge pump working example, they need to buy the Front head's link, that with the inside head cylinder and link allows to use the two pins fixing.

TOP COVER IN TWO OPENINGS

The easy maintenance features of the excavators contribute to maximum uptime, allowing operators to carry out routine checks quickly, then focus on the main task at hand. One example is the top cover in two openings of the telescopic arm, which can be opened easily for inspection.

PERFORMANCE

WORKING RANGES

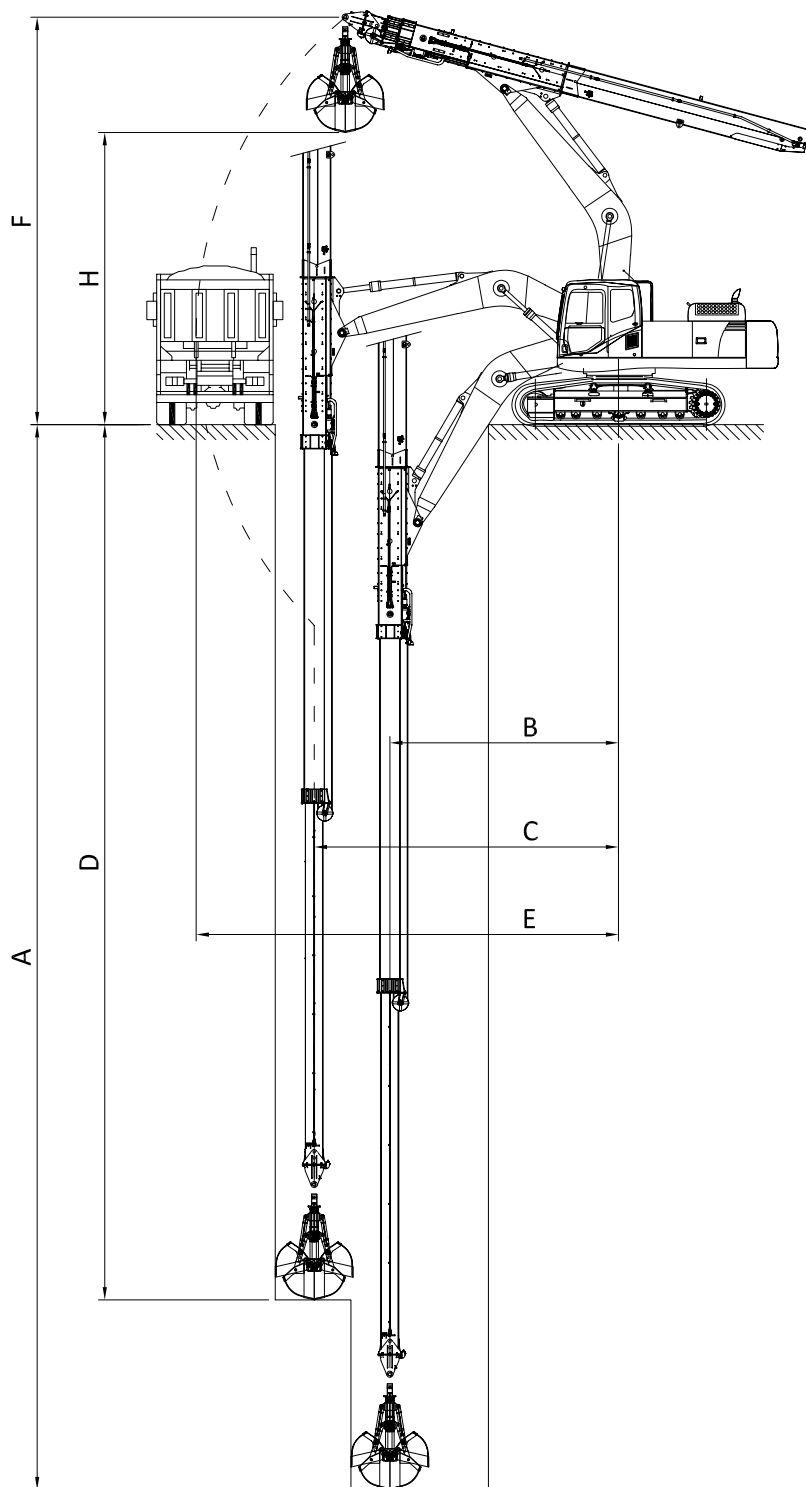

** Speed time with double hydr. pump

The telescopic arm cylinder work with additional hydraulic line of the excavator. If the end attachments requires some hydraulics line supply for working, the excavator must be equipped on additional hydraulic lines.

Code	A	B	C	D	E	F	H	Model	Excavator	Note	Speed in Second		Clamshell bucket Code Cap.ty	Productivity Cu m / Hour from / to
											** Down	Up		
	mt	mt	mt	mt	mt	mt	mt		Ton					
3021TA	23	4.8	6.4	16	9.1	8.2	14,5	TA2325	20 – 25	The Excavator must have additional counter weight	13	10	14296CS 0,8 cum	50 / 65
12605TA	25	5.1	6.8	18	9.5	8.2	15	TA2538	26 – 32		15	14	14297CS 1,0 cum	60 / 80
12605TA	25	5.5	7.2	18.5	10	8.3	15.5	TA2538	33 – 38		14	13	14299CS 1,5 cum	90 / 120
5120TA	30	5.5	7.2	21.5	10	8.3	18.5	TA3038			23	15	14298CS 1,3 cum	80 / 105
13752TA	27	7	7.8	21	11	9	17	TA2750	39 – 50		11	10	14300CS 2,2 cum	130 / 170
14155TA	32	7	7.8	24	11	9	19	TA3250			19	12	14299CS 1,5 cum	90 / 120
14169TA	35	7	7.8	27	11	9	19	TA3550			23	13		80 / 110

TELESCOPIC ARM DIMENSIONS

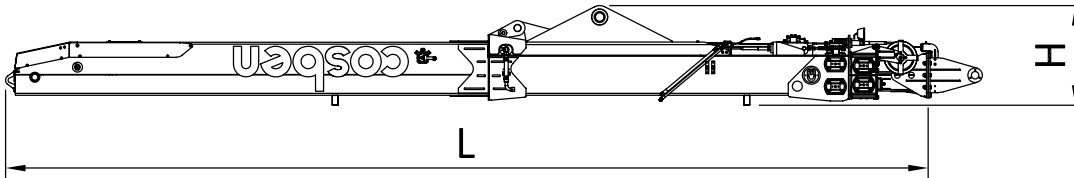

Code	Length mm	Height mm	Width mm	Weight Kg	Container type
3021TA	10300	1000	730	3600	40 FT
12605TA	11500	1300	740	5500	
5120TA	13400	1300	740	6500	45 FT
13752TA	11500	1400	770	6000	40 FT
14155TA	13400	1400	770	7000	45 FT
14169TA	13400	1400	770	7500	

* Without head

SHIPMENT DIMENSION

Code	L Length m	Machine Weight Ton
3021TA	15,7	20 - 25
12605TA	16,2	25 - 32
12605TA	16,7	33 - 38
5120TA	18,4	
13752TA	18	39 - 50
14155TA	18,5	
14169TA	19	

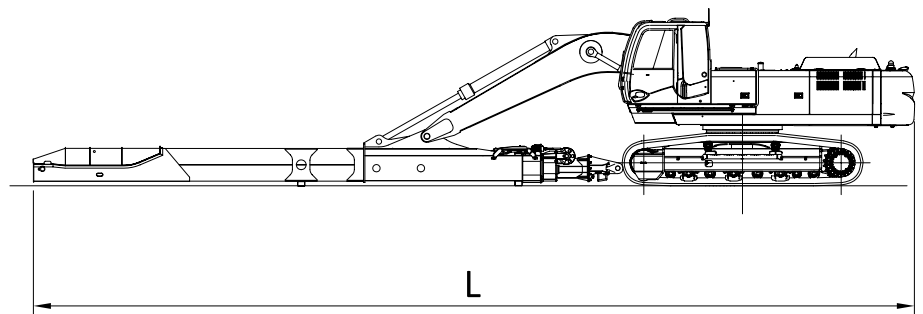

CLAMSHELL BUCKET DIMENSIONS

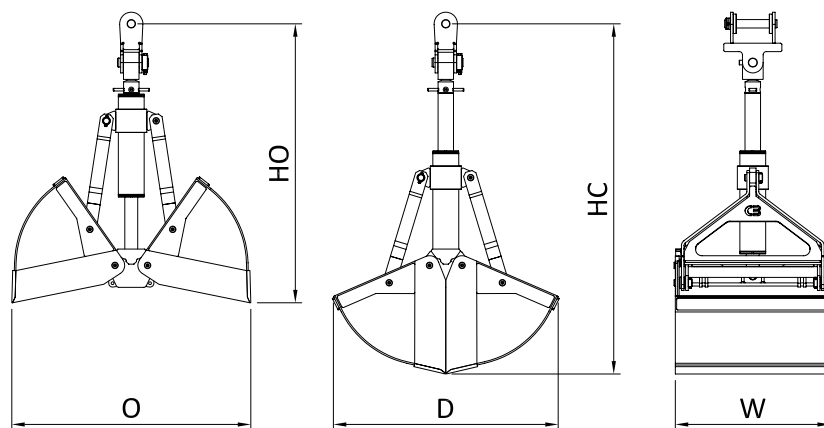

*CS Code	O mm	HO mm	D mm	HC mm	W mm	Teeth No.	Bucket Capacities SAE J67 Lt	Bucket weight Kgr
14296CS	1840	2180	1460	2710	1000	4 + 3	800	1360
14297CS	1840	2180	1740	2710	1000	4 + 3	1000	1415
14298CS	1840	2180	1740	2710	1200	5 + 4	1300	1530
14299CS	1840	2180	1880	2710	1300	5 + 4	1500	1570
14300CS	2080	2200	1970	2840	1500	6 + 5	2200	1830
14271CS	2080	2200	1970	2840	1800	7 + 6	2650	2000



TELESCOPIC ARM



N.B. All data and descriptions are given for information purposes only and they are not binding the manufacturers for any future alteration as they may deem necessary for quality improvement of the attachments.



cosben[®]
EQUIPMENT CONSTRUCTION

Via Carrate, 1/D
41030 SOLARA (MO) - ITALY
Phone +39 059 801056
Fax +39 059 801060
info@cosben-it.com

www.cosben-it.com

